

# THE ARCHITECTURE OF THE PUBLIC LIBRARY

## SANTI ROMERO

Architect. Library buildings adviser, lecturer and teacher

Phone number +34 676 930 408

Email: [santiromerogaruza@gmail.com](mailto:santiromerogaruza@gmail.com)

Web page: <https://santiromeroarquitectura.com>



# A library building must be ...

... identifiable ...



... emblematic ...



... transparent ...



... accessible and inclusive...



... with a spacious entrance lobby from which users can easily find their way to the library's main areas.

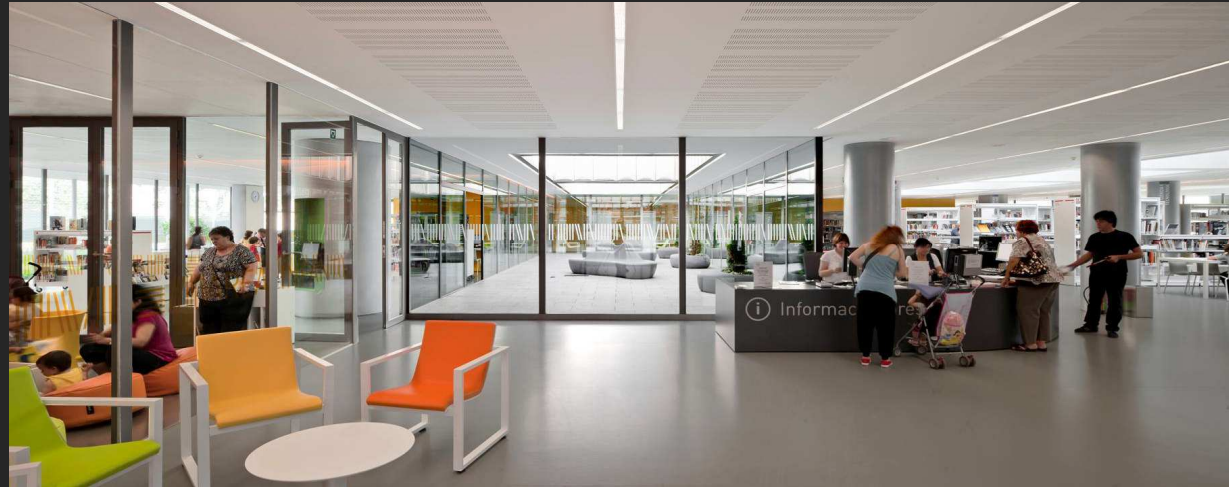

The spatial organization must transmit a sensation of space ...



... and the different areas must interact visually ...





... in such a way that we come across the information we need as we wander through the building.

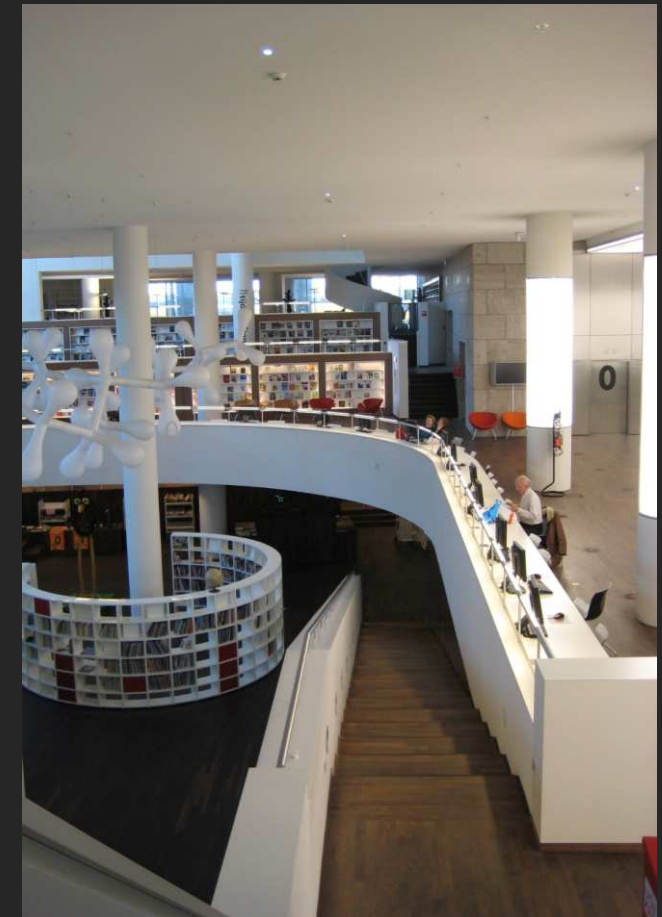

# Different ways of using the library must coexist: The user must have spaces for relaxed work...



...to study in silence...



...work in a group...

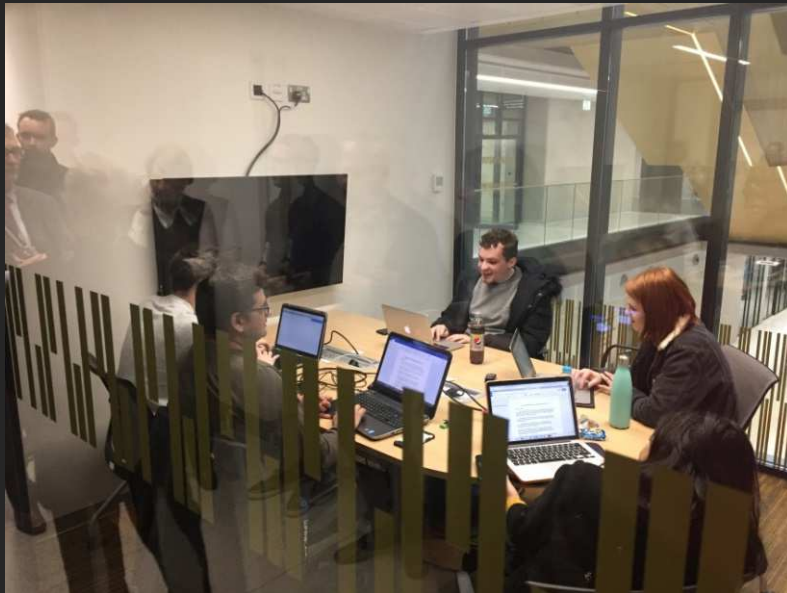

...attend training courses...



... participate in activities that encourage creativity...



... as well as meeting and relationship spaces.



Then there are the children ...





... and parents that accompany them.



All this without the space feeling oppressive or generating visual fatigue.



To ensure the success of the facility ...  
... every user must be able to find their own space ...



... have easy access to IT equipment ...

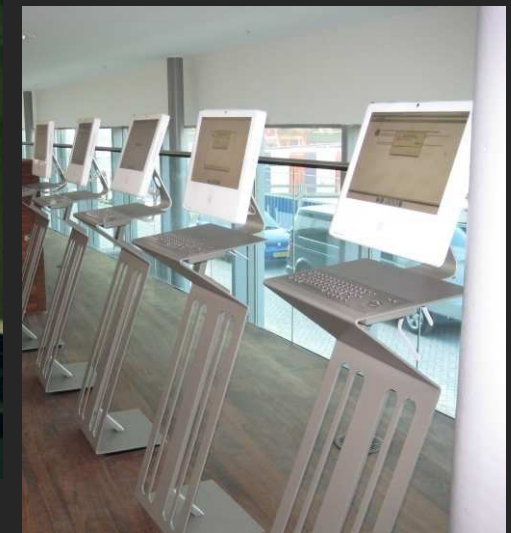
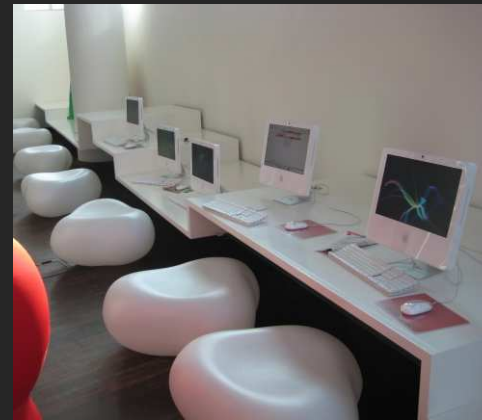

... find a place they can read quietly ...



... enjoy good views ...



... relax in cosy, comfortable and attractive surroundings.



# When we address the organisation of furniture ...

... we must aim to achieve a distribution which is orderly ...





... versatile ...



... which leaves sufficient space between furniture for people to circulate easily ...

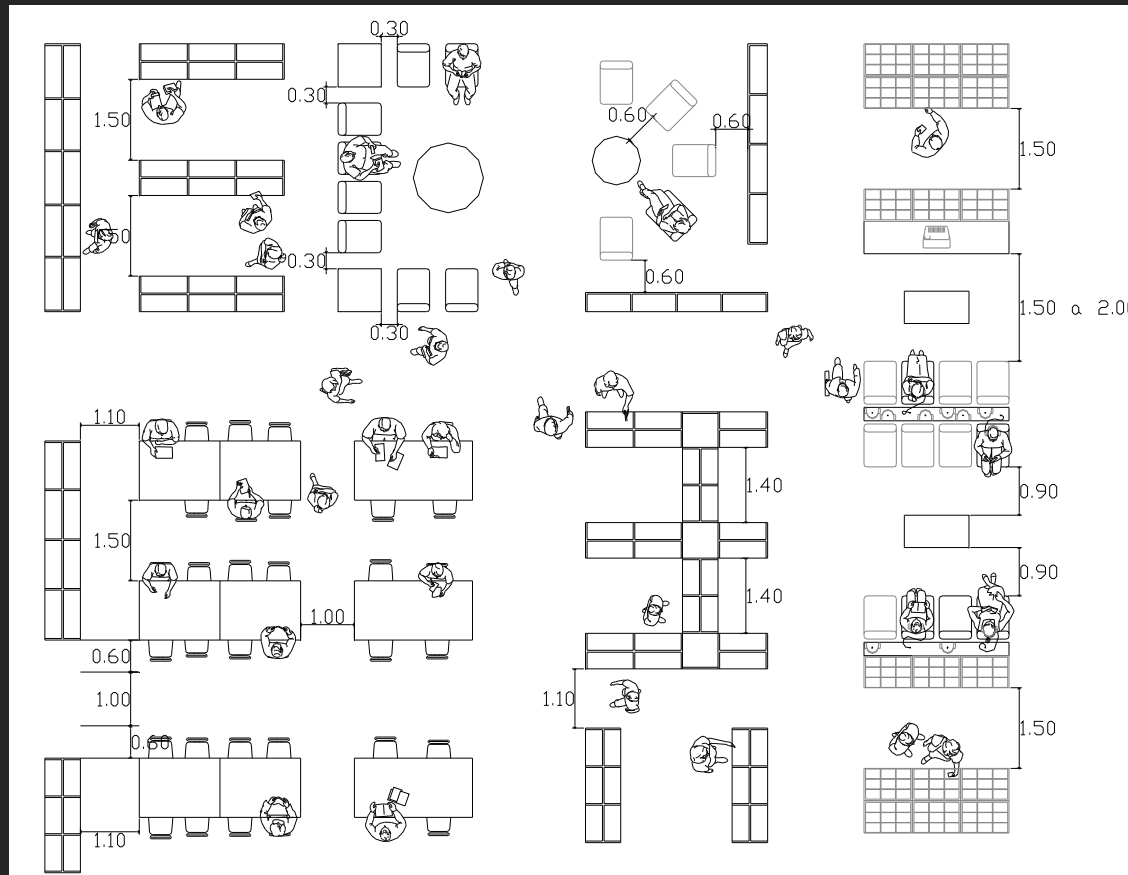

... and respects the space occupied by users.

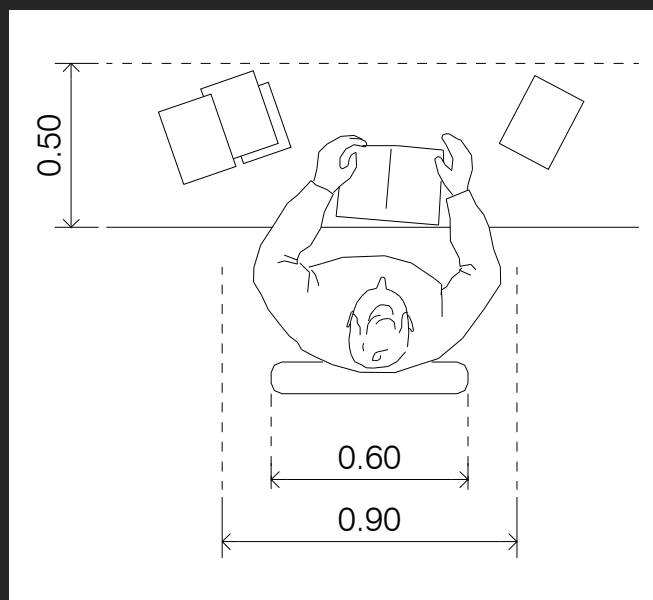
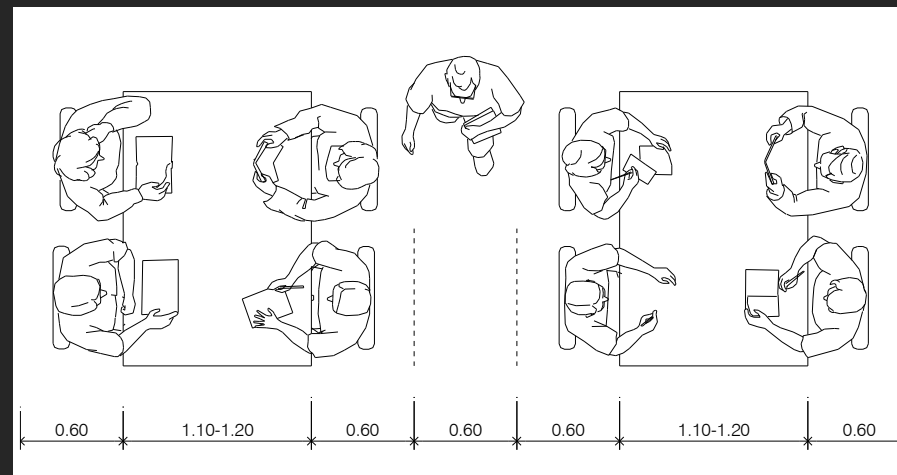
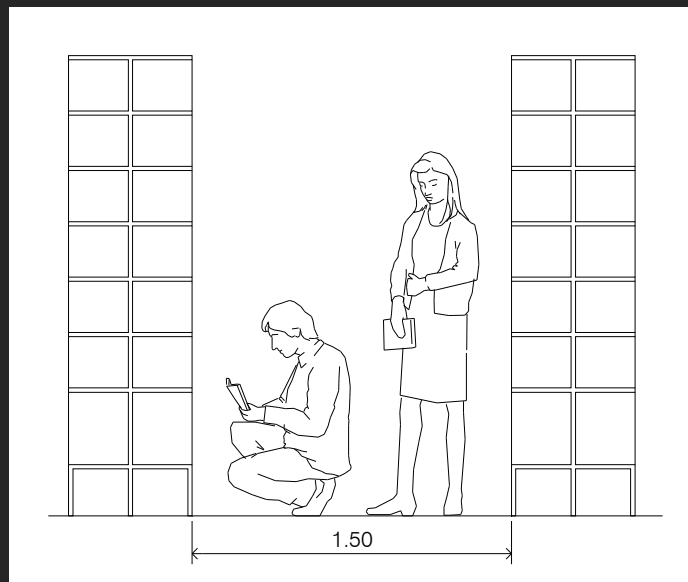

We must also know to capitalise on the use of natural light ...



... and opt for varied and flexible artificial lighting solutions ...



... that are capable of being adapted to different usage scenarios.



Finally, we must incorporate acoustic elements ...



... to absorb the noise inevitably generated by large numbers of people talking and interacting.

